

ITEM NO.	PART NUMBER	DESCRIPTION	MATERIAL	QTY
1	1496STD	95" QUICK-TACH BUCKET	REFER PARTS DETAILS	1
2	1400-22TK-ASSY	SKYTRAK BUCKET QT ASSY	REFER PARTS DETAILS	1
3	D15993	DBFC 5/8" X 8" X 97 7/8" BLADE W/ 16 HOLES	ASTM A36 STEEL	1
4	BOB-01B	5/8-11 X 2 1/2" UNC PLOW BOLT-GRADE 5	STEEL	16
5	BOB-01N	NYLON INSERT LOCKNUT, 5/8-11 UNC	STEEL	16

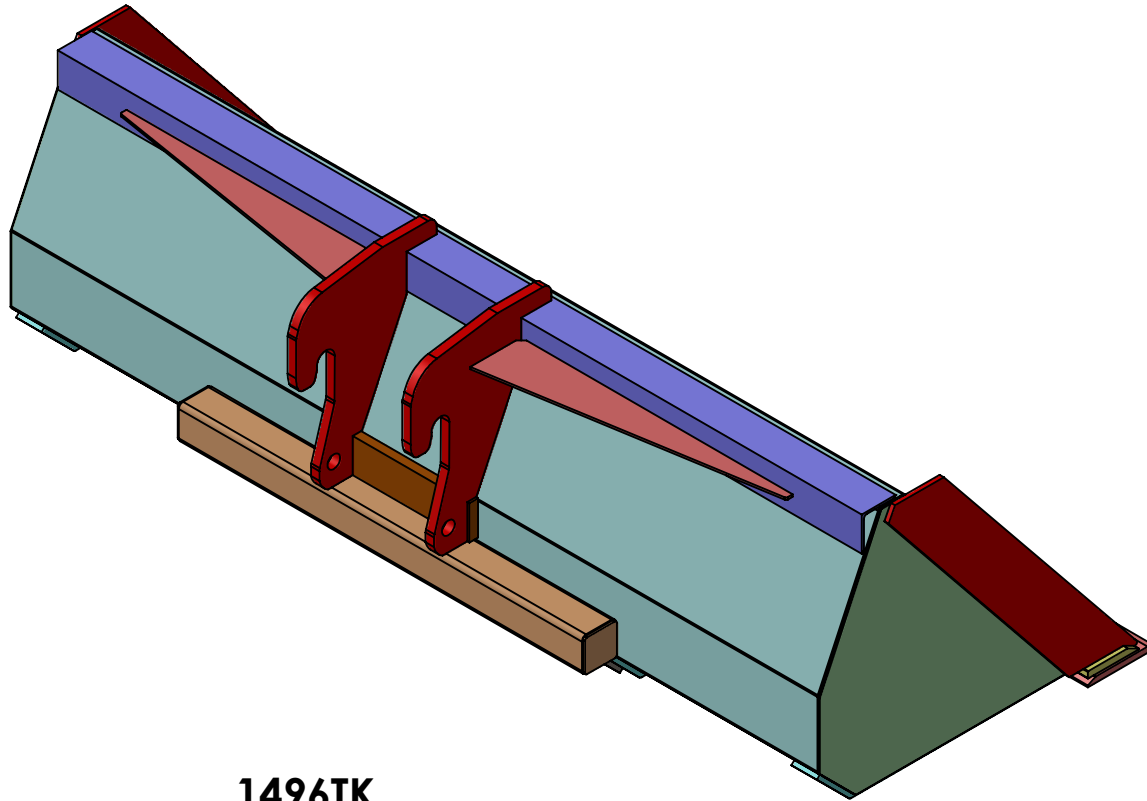

1496TK 95" SKYTRAK COMPATIBLE QUICK-TACH BUCKET

PROPRIETARY AND CONFIDENTIAL
THE INFORMATION CONTAINED IN THIS DRAWING IS THE SOLE PROPERTY OF STAR INDUSTRIES. ANY REPRODUCTION IN PART OR AS A WHOLE WITHOUT THE WRITTEN PERMISSION OF STAR INDUSTRIES IS PROHIBITED.

UNLESS OTHERWISE SPECIFIED:

DIMENSIONS ARE IN INCHES
TOLERANCES: $\pm 1/16$
FRACTIONAL \pm
ANGULAR: MACH \pm BEND \pm
TWO PLACE DECIMAL \pm
THREE PLACE DECIMAL \pm

INTERPRET GEOMETRIC
TOLERANCING PER:

MATERIAL
REFER PARTS DETAILS

FINISH

DO NOT SCALE DRAWING

	NAME	DATE
DRAWN	HI-TECH	8/3/2019
CHECKED		
ENG APPR.		
MFG APPR.		
Q.A.		

COMMENTS:



STAR INDUSTRIES

TITLE:
95" SKYTRAK COMPATIBLE QUICK-TACH BUCKET

SIZE	DWG. NO.	REV
A	1496TK-DLR	0
SCALE: 1:24	WEIGHT: 1019.96 LBS	SHEET 1 OF 2

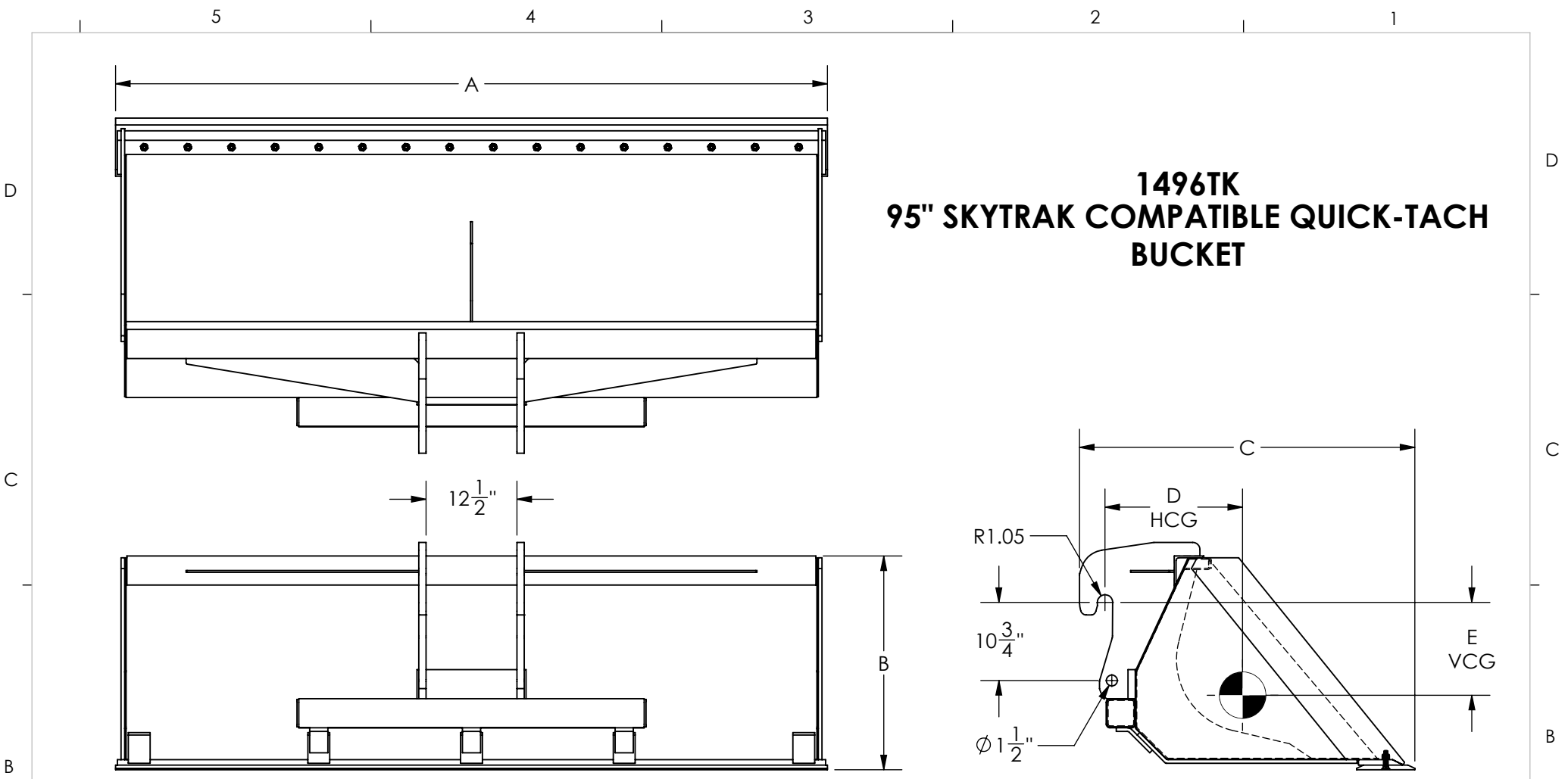

**1496TK
95" SKYTRAK COMPATIBLE QUICK-TACH
BUCKET**

MODEL NO	A	B	C	D	E	BUCKET VOLUME	BUCKET LOAD CAPACITY	EMPTY WEIGHT	LOADED HORZ CG	LOADED VERT CG
1496TK	97 7/8"	29 3/8"	46 1/8"	18 15/16"	12 3/4"	1.25 CYD	4200 LBS	1019.96 LBS	16 5/16"	11"

ALL SKYTRAKS, MOST JLG TELEHANDLERS MANUFACTURED AFTER OCT 2008, GENIE 6K & 8K , JCB WITH NARROW QUICK-TACH, XTREME MODELS XR842, XR1045, XR1245, XR1055, XR1147, XR1245, XR1255, XR1270, XR1470, SR9244, & SR1054. 12.5" BETWEEN THE EARS

SIZE A	DWG. NO. 1496TK-DLR	REV 0
SCALE: NTS	WEIGHT: 1019.96 LBS	SHEET 2 OF 2